

• Thank you for purchasing Whitewood Industries Inc. product. This product has been designed for easy assembly and constructed for durability. Please take the time to read and follow the assembly instructions carefully. If a part or hardware is missing or have any difficulties in assembling this product, Please contact Toll Free 1-888-944-8396.

PARTS LIST :

- 1 SIDE PANEL
- 2 BOTTOM PANEL
- 3 TABLE LEG
- 4 CENTER BASE
- 5 TABLE TOP ASSEMBLY
- 6 BACK PANEL
- 7 CENTER CABINET SHELF
- 8 SIDE OPEN SHELF
- 9 DOOR PANEL
- 10 BANANA SUPPORT

- 2 PCS
- 1 PC
- 4 PCS
- 1 PC
- 1 PC
- 1 PC
- 1 PC
- 2 PCS
- 2 PCS
- 2 PCS

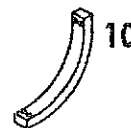
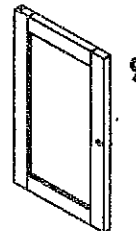
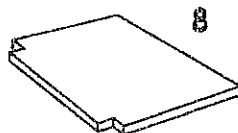
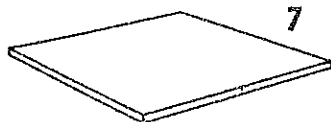
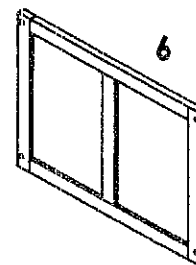
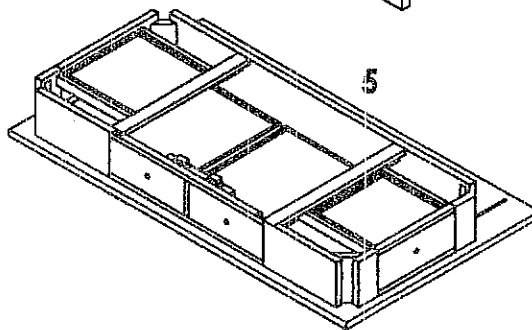
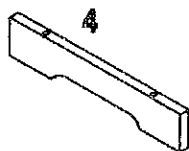
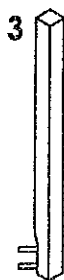
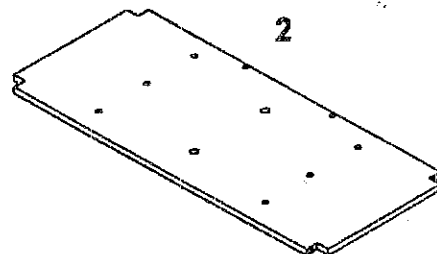
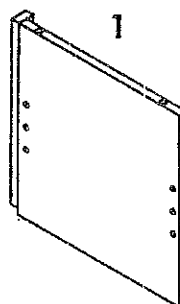

Assembly Instructions
MODEL NO. : WC/WC55-6034
KITCHEN WORK CENTER

HARDWARE LIST :

| | | |
|---|------------------------------------|--------|
| A | SHORT PAN HEAD WOOD SCREW-M4x16MM | 28 PCS |
| B | MEDIUM PAN HEAD WOOD SCREW-M4x30MM | 8 PCS |
| C | LONG PAN HEAD WOOD SCREW-M4x38MM | 10 PCS |
| D | WOOD DOWEL-M10x30MM | 14 PCS |
| E | JCBC SCREW-M6x40MM | 6 PCS |
| F | HEXAGON NUT-5/16" | 8 PCS |
| G | SPRING WASHER-5/16" | 8 PCS |
| H | FLAT WASHER-5/16" | 8 PCS |
| I | "L" BRACKET | 8 PCS |
| J | SHELF PIN | 8 PCS |
| K | "L" SHELF PIN | 4 PCS |
| L | WOOD KNOB-DIA.34MM | 6 PCS |
| M | ROLLER CATCH-MALE | 2 PCS |
| N | ROLLER CATCH-FEMALE | 2 PCS |
| O | DOOR PIN | 2 PCS |
| P | ALLEN KEY-M4 | 1 PC |
| Q | TRUSS HEAD SCREW | 6 PCS |
| R | WRENCH-12.8MM | 1 PC |
| S | ADJUSTABLE GLIDE | 2 PCS. |
| T | SPRING DOOR PIN | 2 PCS. |

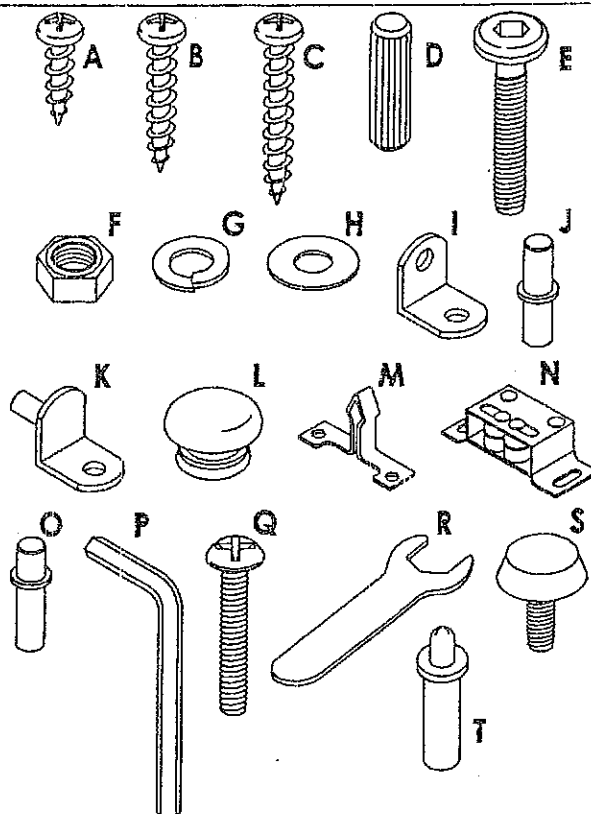

TOOLS REQUIRED (NOT INCLUDED) :

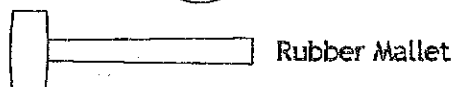
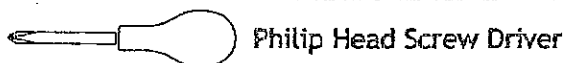

IMPORTANT NOTE :

- Place all wooden parts on a clean and smooth surface such as a rug or carpet to avoid the parts from being scratched. Check to be sure that you have all parts and hardware. Remove all wrapping materials, including staples & packing straps before you start to assemble.
- Keep all hardware parts out of reach of children.
- **DO NOT TIGHTEN BOLTS/SCREWS UNTIL ALL COMPLETELY ASSEMBLED.**

1

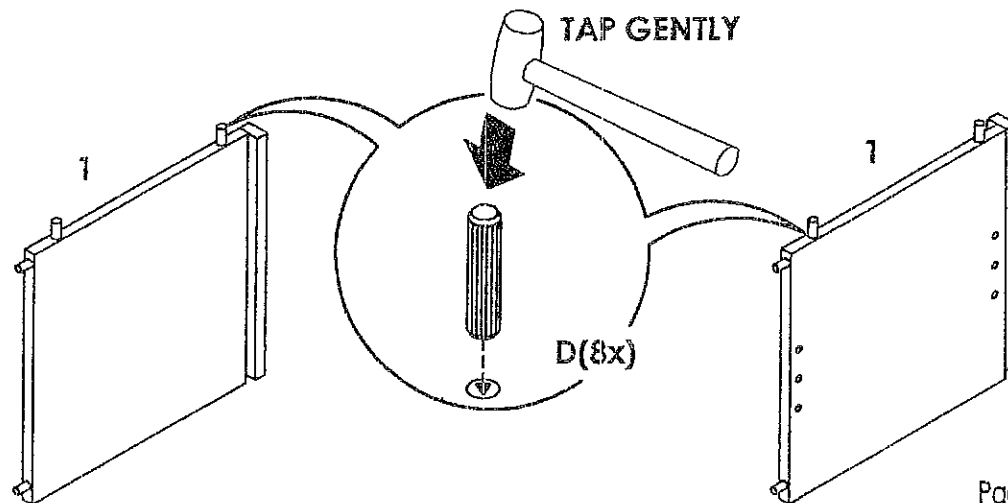

Assembly Instructions
MODEL NO. : WC/WC55-6034
KITCHEN WORK CENTER

2

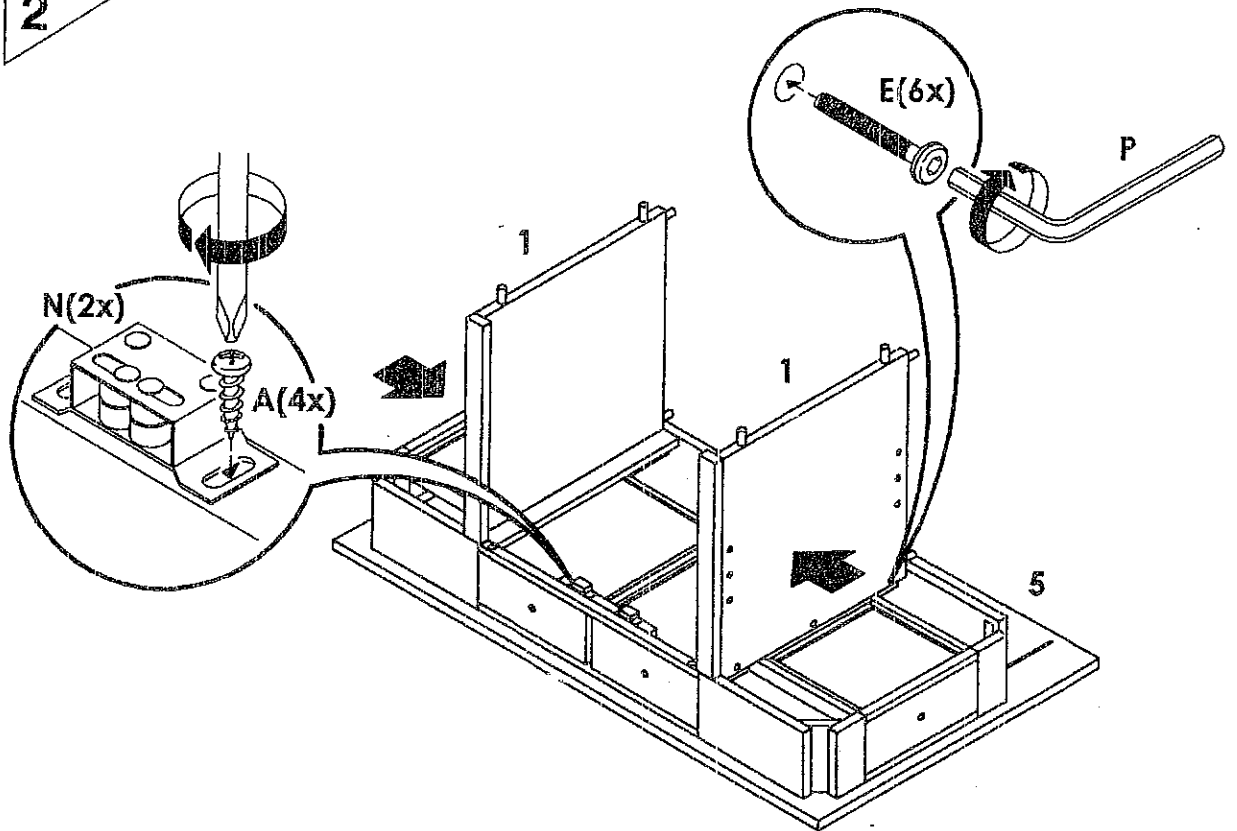

3

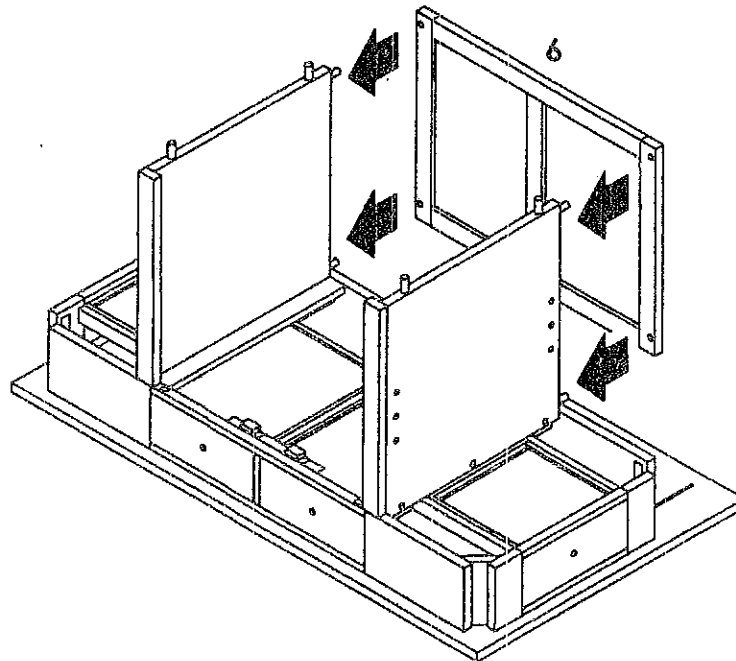

Assembly Instructions
MODEL NO. : WC/WC55-6034
KITCHEN WORK CENTER

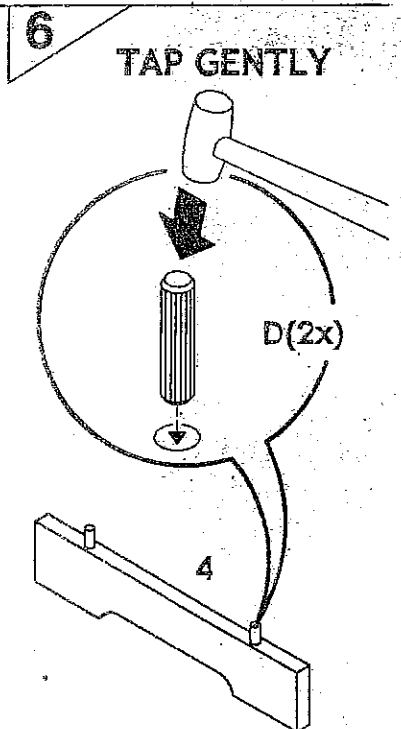
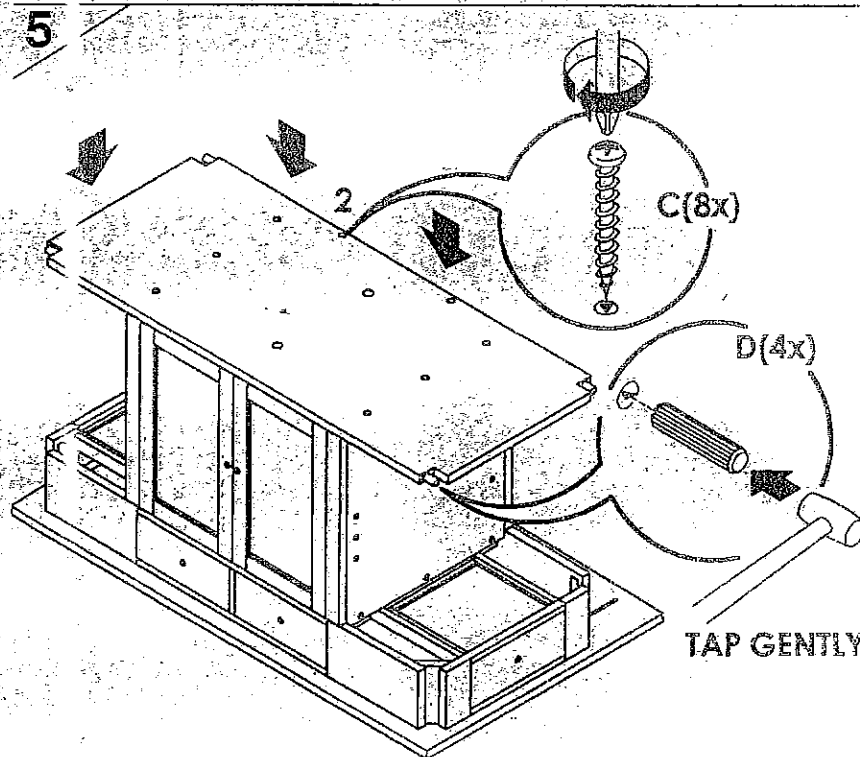
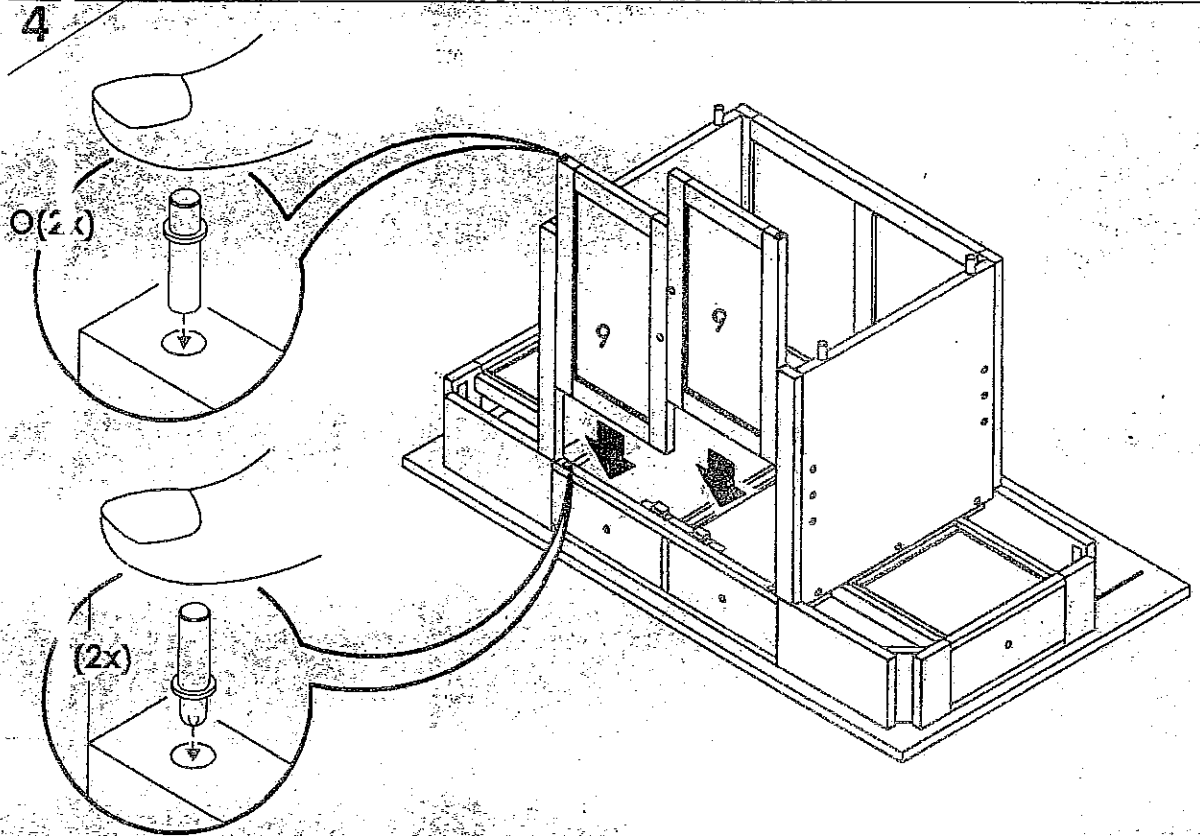

Assembly Instructions
MODEL NO. : WC/WC55-6034
KITCHEN WORK CENTER

7

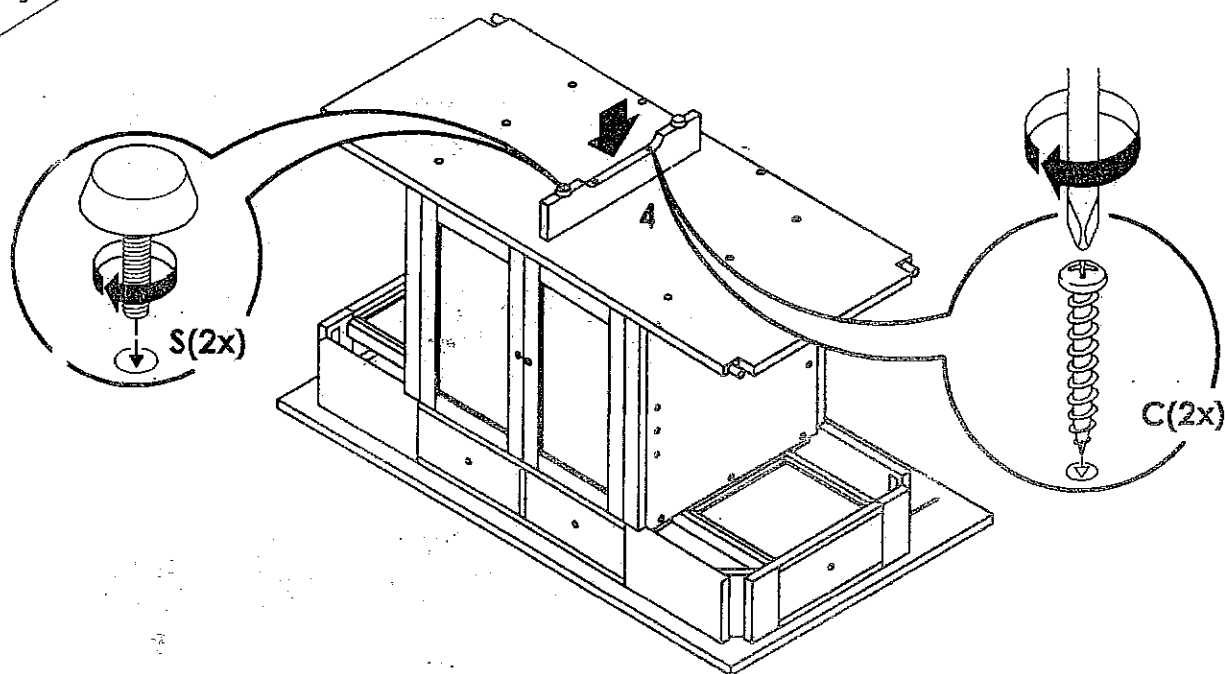

8

*** PLEASE REMOVE PLASTIC
 PROTECTING CAP BEFORE
 ASSEMBLE LEG TO TOP.**

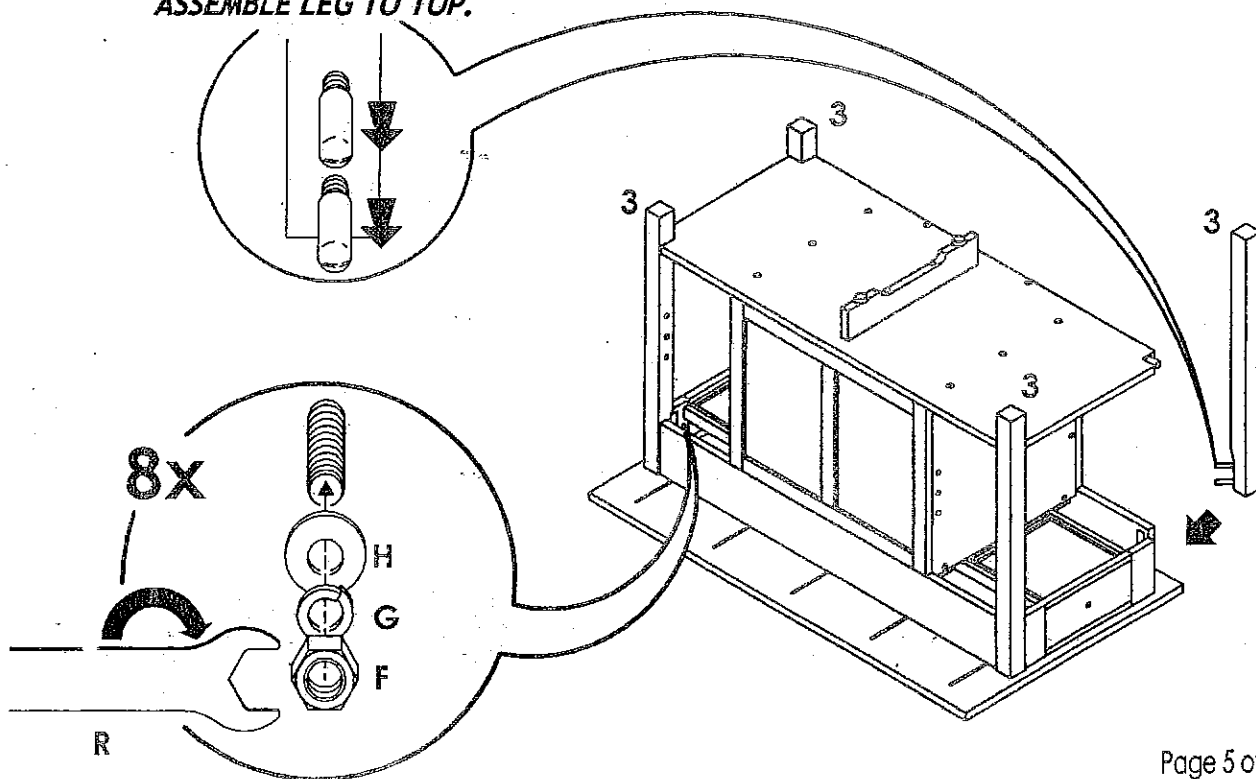

Assembly Instructions
MODEL NO. : WC/WC55-6034
KITCHEN WORK CENTER

9

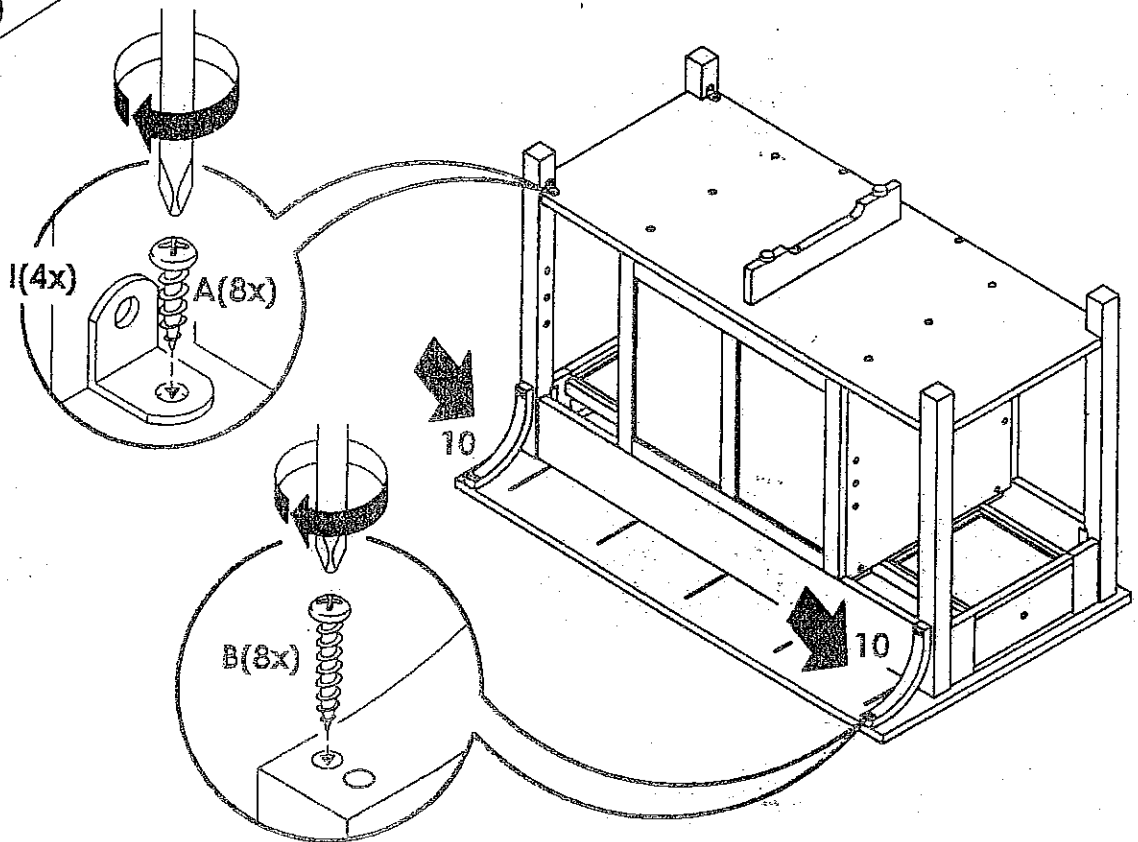

10

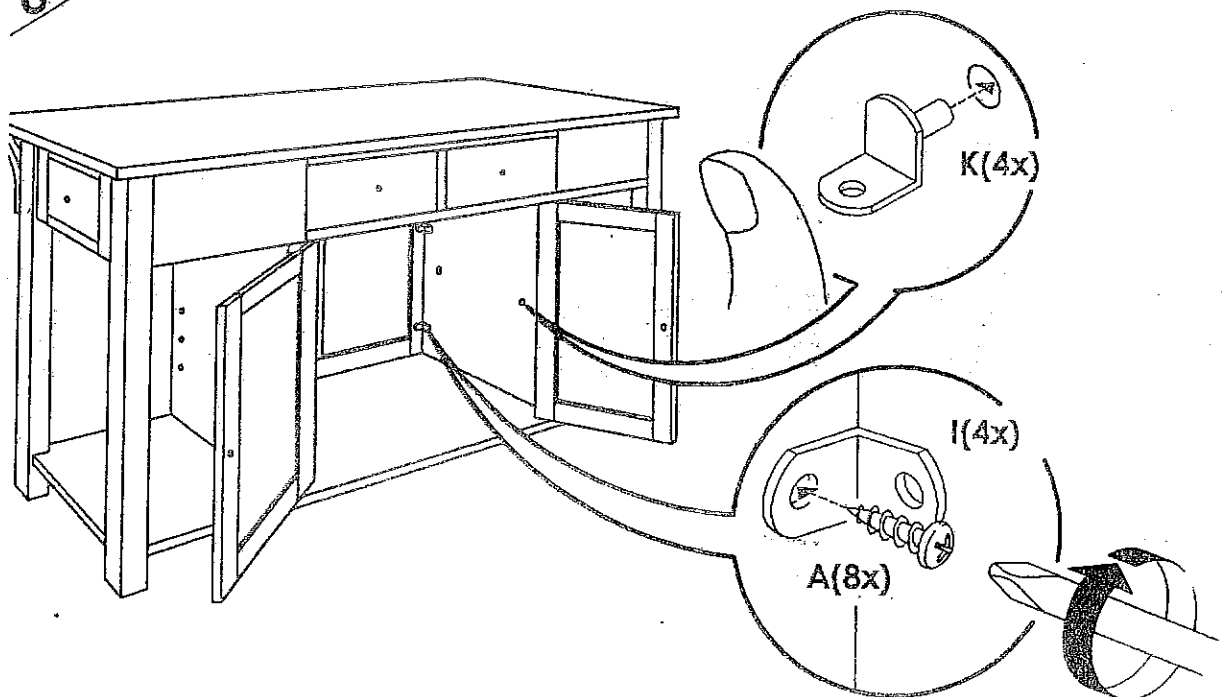

Assembly Instructions
MODEL NO. : WC/WC55-6034
KITCHEN WORK CENTER

11

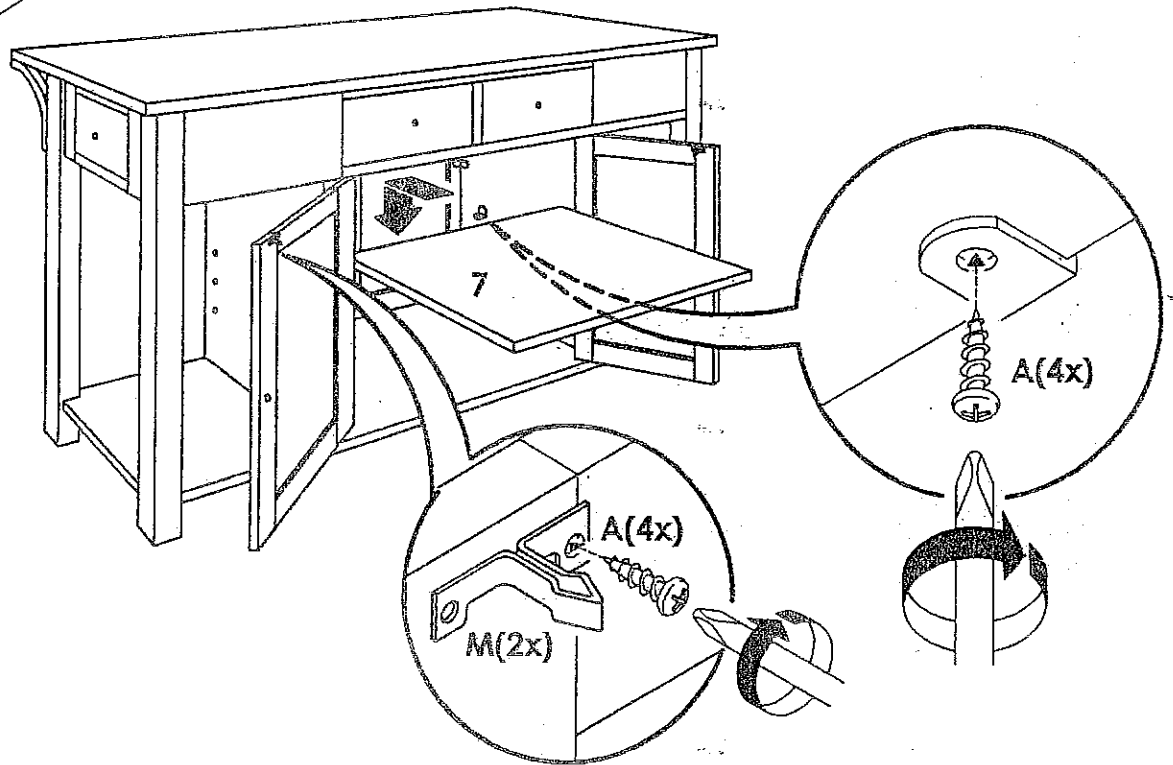

12

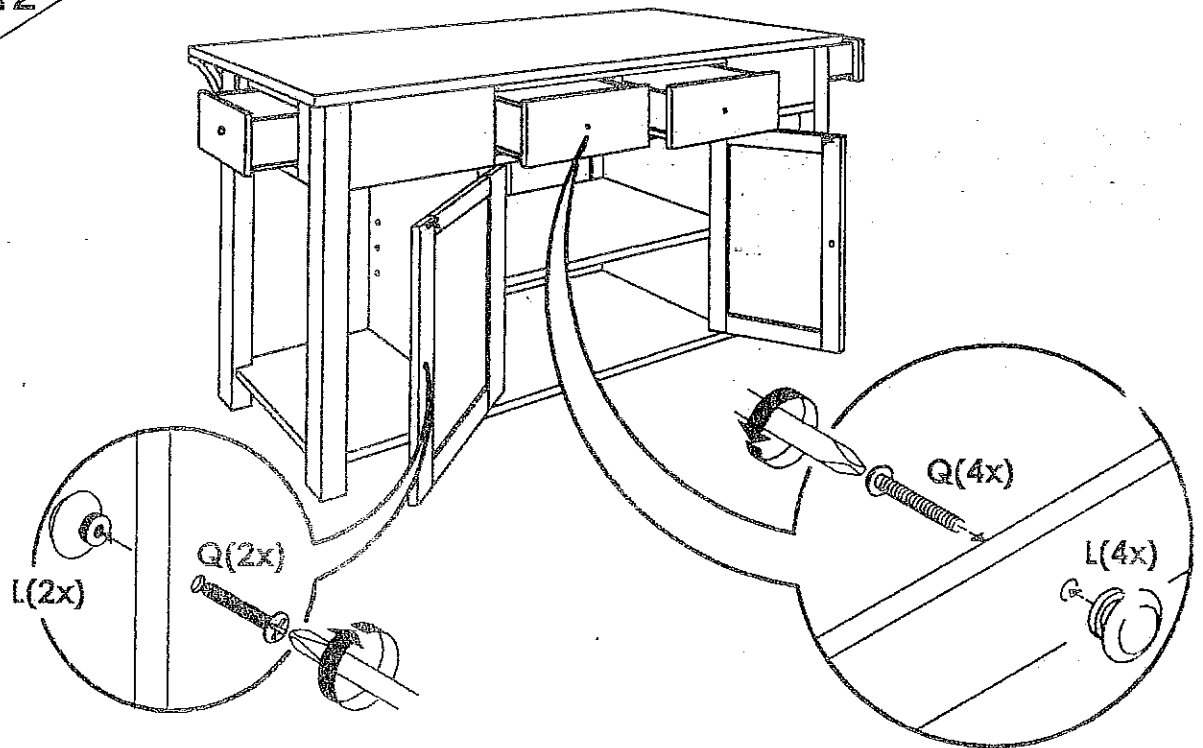

13

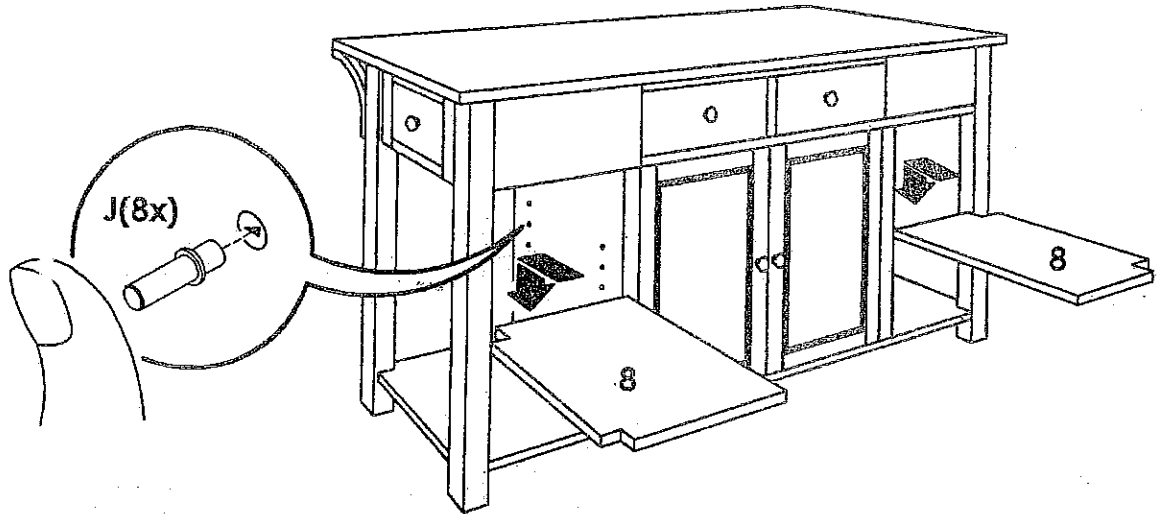

14

TO REMOVE DOORS

* Draw out drawers first if you want to remove doors.

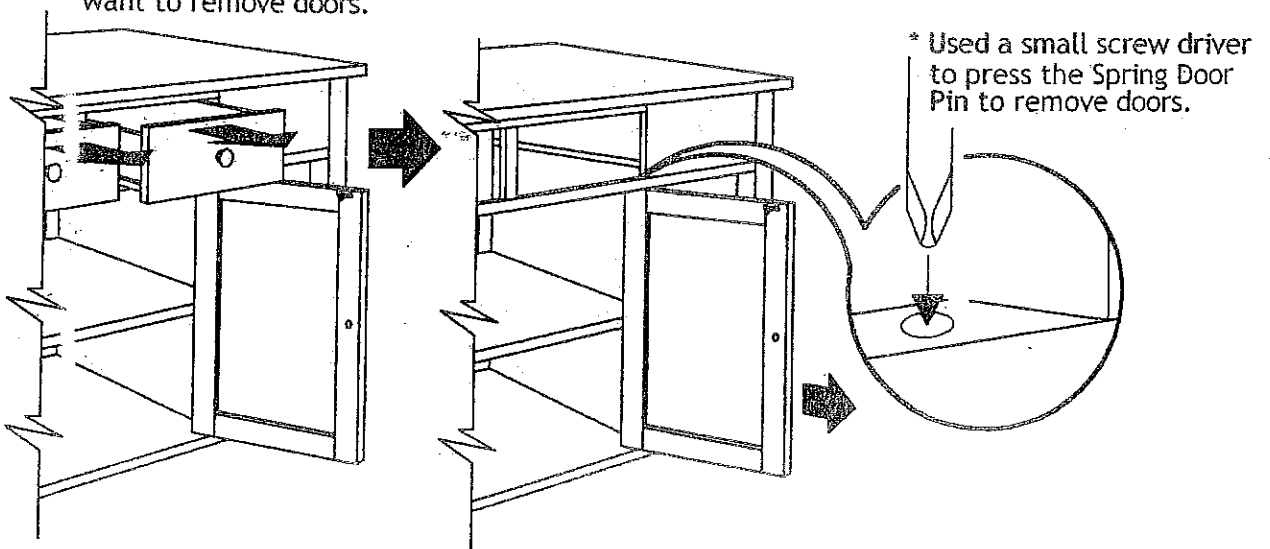

CARE AND MAINTENANCE !

• The touch of a soft cloth is all the maintenance your wood pieces will ever need. Never use harsh chemicals or abrasive cleaners, as they could mark or destroy finish.

MADE IN MALAYSIA